



ACOUSTIC CEILINGS

Breeze Baffles

Acoustic ceiling baffles

Breeze ceiling baffles are an ideal solution to manage reverberation across large open-plan spaces creating a more comfortable acoustic environment. The acoustic ceiling baffles are designed to be suspended vertically and come in a range of shapes, sizes and colours to suit any design and complement client branding allowing you to transform a ceiling.



FEATURES

- ▶ Available in 12mm and 24mm thickness
- ▶ Made using GRS-certified fibres containing 99% recycled content
- ▶ No formaldehyde binders
- ▶ Low VOCs
- ▶ LBC Red List Free
- ▶ Created in-house delivering fast lead times and complete creative control
- ▶ Exciting range of designs provides visual interest to ceilings
- ▶ Not affected by moisture, mould or mildew
- ▶ Lightweight for easy installation
- ▶ Comes with aluminium channels pre-fitted
- ▶ Easily retro-fitted to ceilings
- ▶ EN 13501-1:2018-B, s1, d0; ASTM E84 -16 - Class A
- ▶ BIM files available to download from www.allsfar.com

ÖRA COLOURS*



REJUVENATE PALETTE



REFINE PALETTE



REFRESH PALETTE



* Please include felt colour when ordering.

Breeze Baffles, 12mm - Straight

CODE	DESCRIPTION	DIMENSIONS (mm)	ORDER QTY MULTIPLE
BRE12-1200-200	Suspended ceiling baffles, Straight	12W x 1200L x 200H	12
BRE12-2400-200	Suspended ceiling baffles, Straight	12W x 2400L x 200H	6
BRE12-1200-300	Suspended ceiling baffles, Straight	12W x 1200L x 300H	8
BRE12-2400-300	Suspended ceiling baffles, Straight	12W x 2400L x 300H	4
BRE12-BESPOKE	Suspended ceiling baffles, Straight	Please specify	Subject to quotation

Breeze Baffles, 24mm - Straight

CODE	DESCRIPTION	DIMENSIONS (mm)	ORDER QTY MULTIPLE
BRE24-1200-200	Suspended ceiling baffles, Straight	24W x 1200L x 200H	12
BRE24-2400-200	Suspended ceiling baffles, Straight	24W x 2400L x 200H	6
BRE24-1200-300	Suspended ceiling baffles, Straight	24W x 1200L x 300H	8
BRE24-2400-300	Suspended ceiling baffles, Straight	24W x 2400L x 300H	4
BRE24-BESPOKE	Suspended ceiling baffles, Straight	Please specify	Subject to quotation

2No suspension wire kits needed per baffle - sold separately.

Alternative bespoke sizes or fabric wrapped finish available on request.

For woodgrain use code "BRES24"

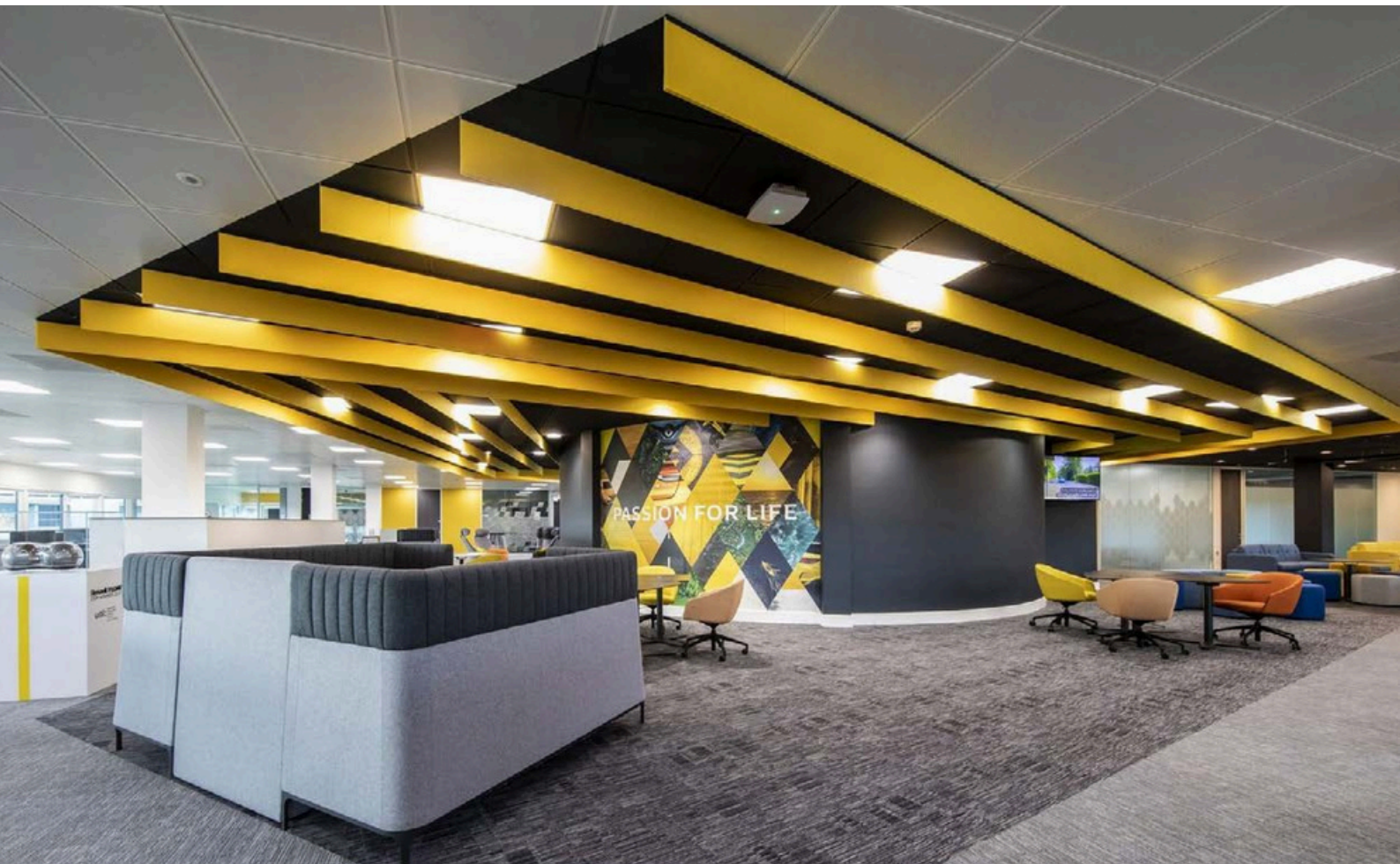

Breeze Wavy Baffles, 12mm - Wavy

Available in Öra PET colour finishes only

CODE	DESCRIPTION	DIMENSIONS (mm)	ORDER QTY MULTIPLE
BREW12-1200-250	Suspended ceiling baffles, Wavy	12W x 1200L x 150-250H	12
BREW12-2400-250	Suspended ceiling baffles, Wavy	12W x 2400L x 150-250H	6
BREW12-1200-350	Suspended ceiling baffles, Wavy	12W x 1200L x 250-350H	8
BREW12-2400-350	Suspended ceiling baffles, Wavy	12W x 2400L x 250-350H	4
BREW12-BESPOKE	Suspended ceiling baffles, Wavy	Please specify	Subject to quotation

Breeze Wavy Baffles, 24mm - Wavy

Available in Öra PET colour finishes only

CODE	DESCRIPTION	DIMENSIONS (mm)	ORDER QTY MULTIPLE
BREW24-1200-250	Suspended ceiling baffles, Wavy	24W x 1200L x 150-250H	12
BREW24-2400-250	Suspended ceiling baffles, Wavy	24W x 2400L x 150-250H	6
BREW24-1200-350	Suspended ceiling baffles, Wavy	24W x 1200L x 250-350H	8
BREW24-2400-350	Suspended ceiling baffles, Wavy	24W x 2400L x 250-350H	4
BREW24-BESPOKE	Suspended ceiling baffles, Wavy	Please specify	Subject to quotation

2No suspension wire kits needed per baffle - sold separately.

Colour coated aluminium mounting channel included.

Alternative bespoke sizes available on request.

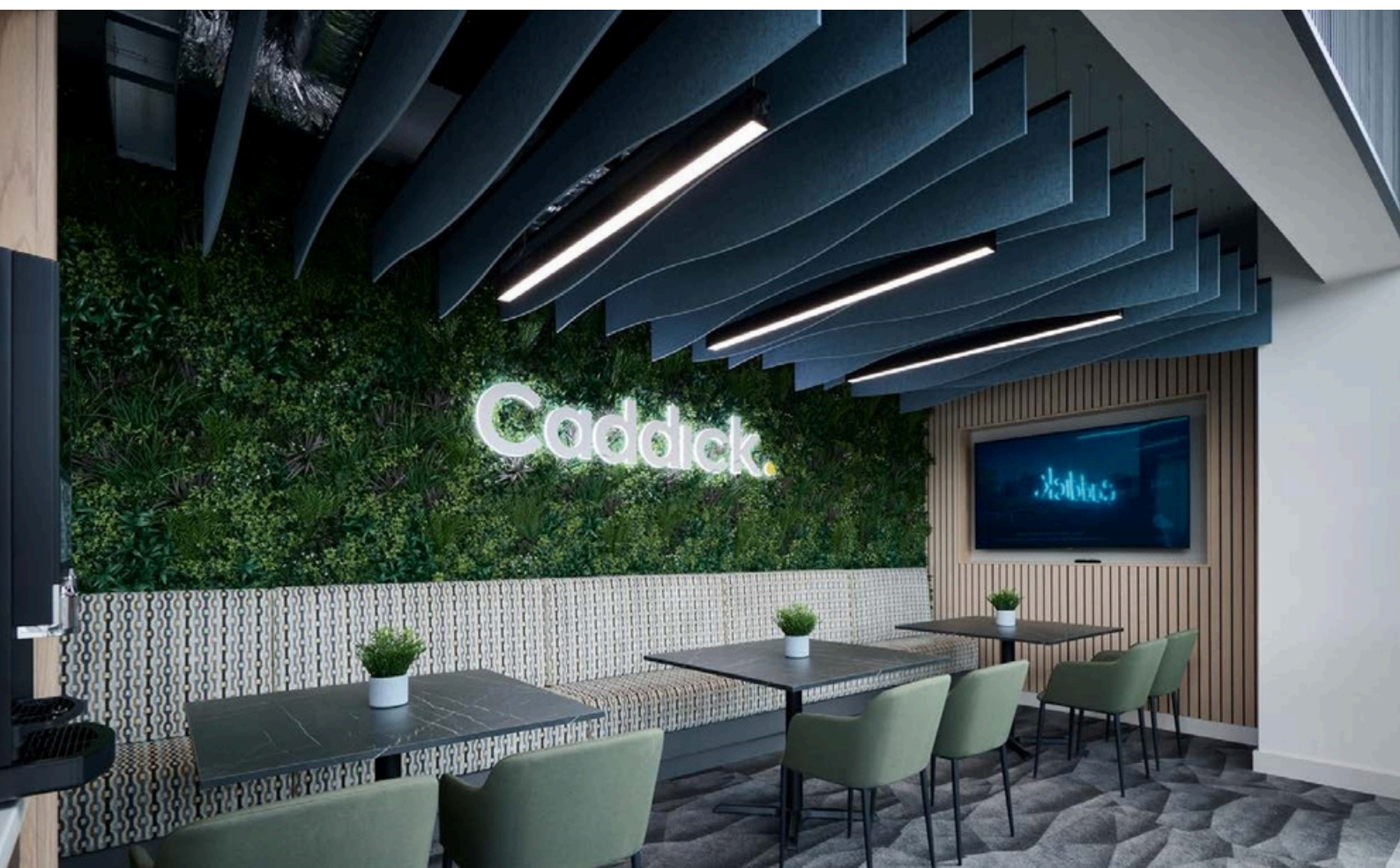

BREEZE ACOUSTIC CEILING BAFFLES 24MM SOUND ABSORPTION COEFFICIENT

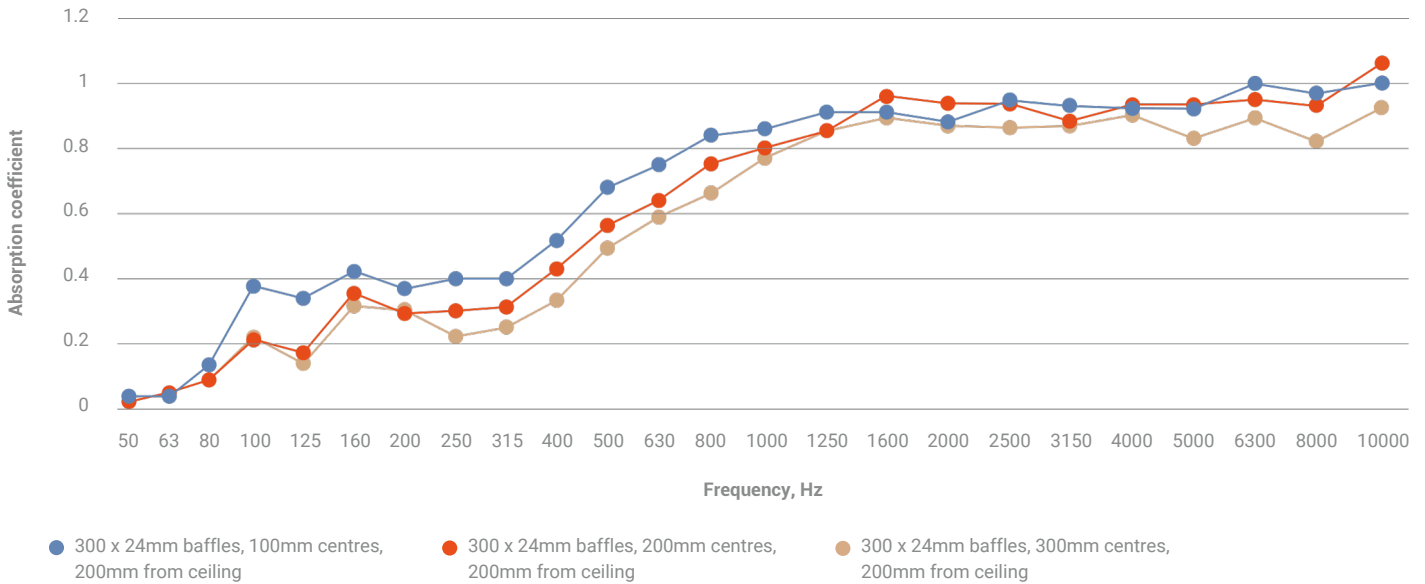

BREEZE ACOUSTIC CEILING BAFFLES 24MM SOUND ABSORPTION COEFFICIENT

300 X 24MM BAFFLES,
100MM CENTRES,
200MM FROM CEILING

300 X 24MM BAFFLES,
200MM CENTRES,
200MM FROM CEILING

300 X 24MM BAFFLES,
300MM CENTRES,
200MM FROM CEILING

Freq Hz	Absorb Coeff α_w	Absorb Coeff α_w	Absorb Coeff α_w
50	0.04	0.02	0.02
63	0.04	0.05	0.05
80	0.14	0.09	0.09
100	0.38	0.21	0.22
125	0.34	0.17	0.14
160	0.42	0.35	0.32
200	0.37	0.29	0.30
250	0.40	0.30	0.22
315	0.40	0.31	0.25
400	0.52	0.43	0.33
500	0.68	0.56	0.49
630	0.75	0.64	0.59
800	0.84	0.75	0.66
1000	0.86	0.80	0.77
1250	0.91	0.85	0.85
1600	0.91	0.96	0.89
2000	0.88	0.94	0.87
2500	0.95	0.94	0.86
3150	0.93	0.88	0.87
4000	0.92	0.93	0.90
5000	0.92	0.93	0.83
6300	1.00	0.95	0.89
8000	0.96	0.93	0.82
10000	1.00	1.06	0.89
NRC	0.70	0.65	0.60
Alpha w	0.65(H)	0.55(MH)	0.50(MH)
Class	C	D	D



Declare.

Breeze
AIISfär

Final Assembly: Watford, United Kingdom
Life Expectancy: 25 Year(s)
End of Life Options: Salvageable/Reusable in its Entirety, Recyclable (100%)

Ingredients:
 Polyethylene Terephthalate; Aluminum alloy, C. I. Pigment Blue 15; Aluminum hydroxide; Octadecanoic acid, sodium salt

Living Building Challenge Criteria:

I-13 Red List:
 LBC Red List Free % Disclosed: 100% at 100ppm
 LBC Red List Approved VOC Content: Not Applicable
 Declared

I-10 Interior Performance: Not Compliant
I-14 Responsible Sourcing: Not Applicable

ALL-0003
 EXP. 01 JUL 2026
 Original Issue Date: 2025

MANUFACTURE RESPONSIBLE FOR LABEL ACCURACY
 INTERNATIONAL LIVING FUTURE INSTITUTE™ living-future.org/declare

Care Instructions

Our products are extremely durable and require little attention to maintain their good looks. Light dusting on a regular basis will prevent dust build up and most marks can be cleaned with a mild detergent solution followed by rinsing and blotting. Stains should be dealt with according to the chart below.

Before carrying out a proposed cleaning method, apply to a concealed section to ensure it will not affect the product or adhesive. Avoid cleaning methods that create severe abrasion. NB: Solvent and mineral based cleaners should be used sparingly to avoid possible degradation of the adhesive adhering the product to the substrate.

Professional Cleaning Methods

Stain	Treatment Guide
Blood	A, C
Burn/Scorch Mark	K
Chewing Gum	I, B, D, C
Chocolate	B, D, C
Cooking Oils	B, D, C
Crayon/Colour Markers	B, D, C
Drinks	A, C
Dust/Dirt	Vacuum, then J or C
Excrement	B, C
Grass	C
Grease	B, D, C
Ink (ballpoint)	D, E
Ink (fountain)	A, C
Lipstick	B, E, C, D
Mildew	C
Milk	A, E
Mud	B, C
Nail Polish	A, G
Oil	B, D, C
Paint (water based)	A, F, C
Paint (oil based)	A, H, D, C
Sauces	B, C, D
Shoe Polish	B, C, D
Urine	A, C
Vomit	A, C, D
Wine	A, Add Salt, C

Key

- A** Mop up excess as soon as possible with a sponge or cloth.
- B** Remove surplus with a knife edge or appropriate instrument.
- C** Sponge with a solution of carpet shampoo working from well outside the stain in a circular motion towards the centre (this avoids spreading the stain). Sponge afterwards with clean warm water and mop excess moisture with a clean dry cloth or sponge. Allow to dry then brush gently with a soft brush. If any stain remains, sponge with a solution of one part household bleach to six parts clear water. Thoroughly rinse after treatment.
- D** Lightly sponge with household dry cleaning fluid and blot. Apply sparingly, as the substance may have an adverse effect on the adhesive.
- E** Sponge with methylated spirits and blot dry.
- F** Lubricate the stain with glycerine or petroleum jelly.
- G** Apply nail polish remover. The nail polish remover should not include lanolin or be of a greasy nature.
- H** Sponge with turpentine (or substitute).
- I** Freeze with ice cubes and scrape away while cold.
- J** Clean with regular extractive carpet cleaner (if possible).
- K** Use circular cutter and remove damaged portion. Re-glue new piece into place.

Please contact us for a detailed installation guide.

Showroom: 14 Baltic Street East, London, ECIY 0UJ

Head Office and Factory: Aspect Gate, 1 Olds Approach, Watford, WD18 9RF

www.allsfar.com • +44 (0)20 3889 9888 • hello@allsfar.com

